

THE  GRAYSON



“Elevation A” is shown w/optional porch rails.
Artist Rendering for illustration purposes only. Town code requires double garage doors not shown. Please review architectural drawings for accuracy.

Optional Elevations

Elevation B



Elevation C



THE GRAYSON

Total living: 2,153 SF
Garage: 523 SF

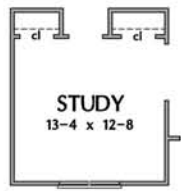
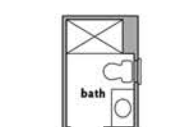
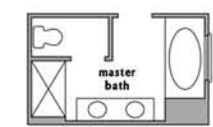
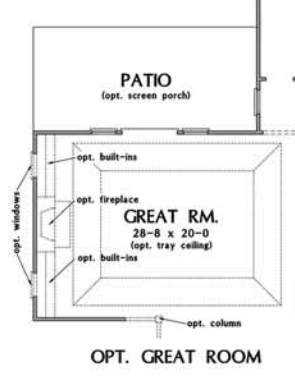
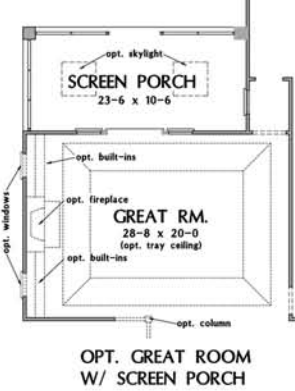
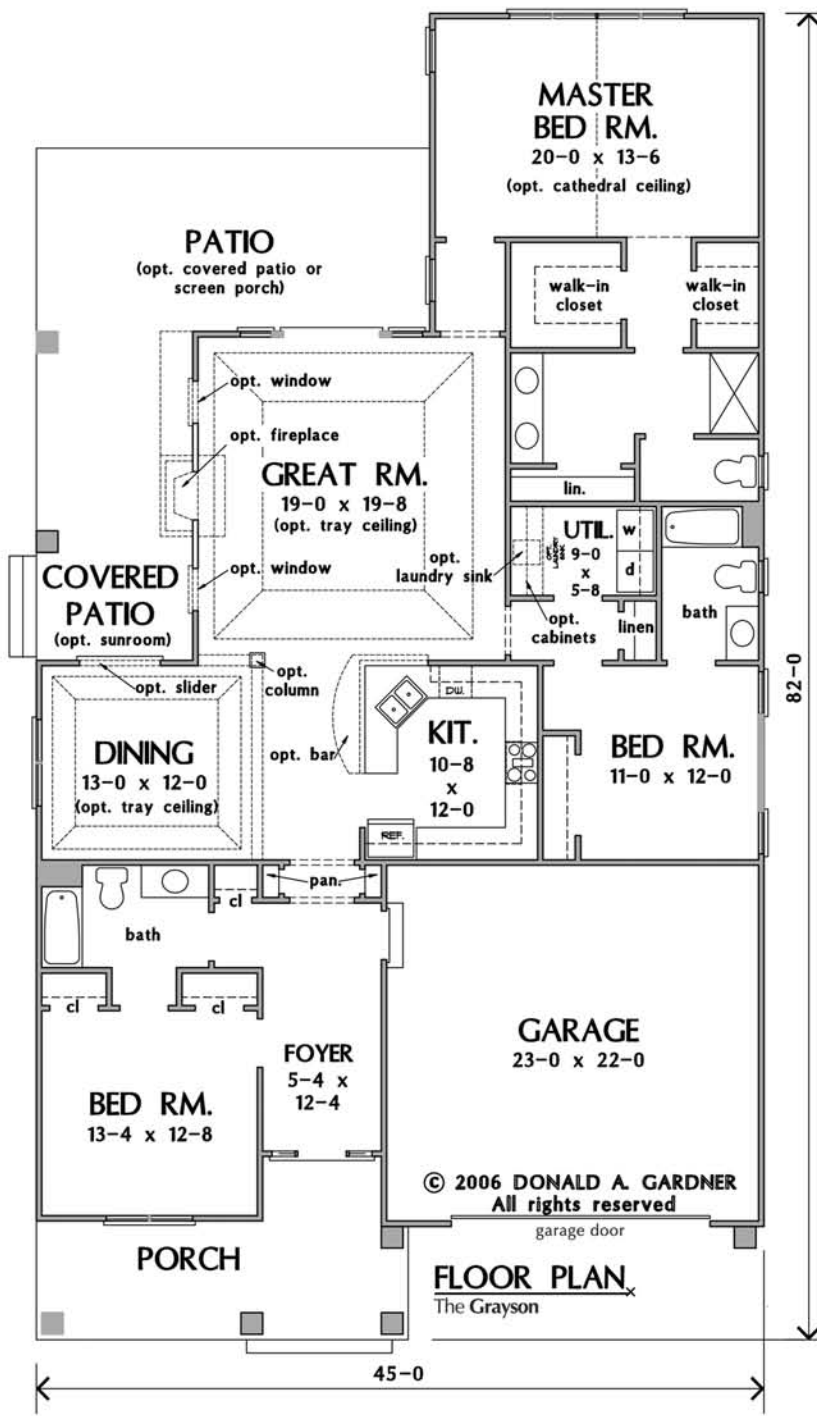
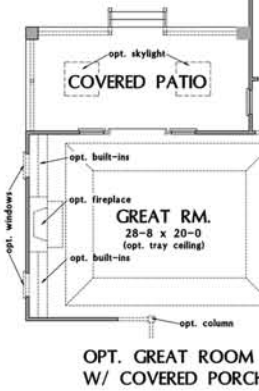
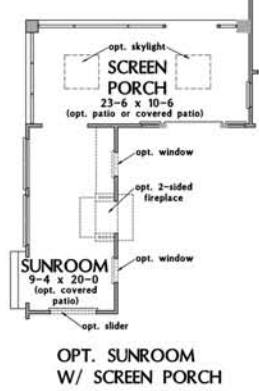
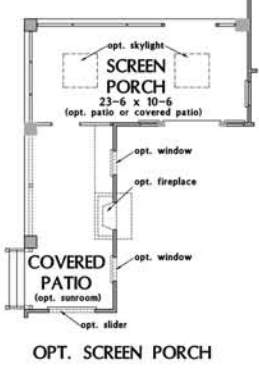
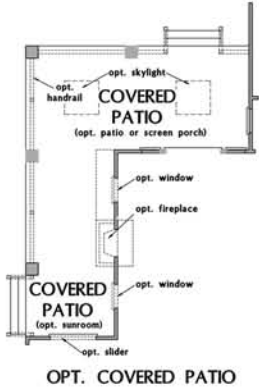
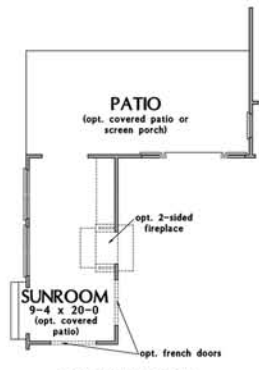

OPTIONAL FLOOR PLANS

All dimensions are approximate. Purchasers must review detailed architectural drawings available in the sales office to ensure accuracy and understanding of the home chosen. Windows configurations may vary based upon elevation chosen. 6/30/2009

